

## KGC-TYPE

### DIMENSIONS

#### KGC-2847 SERIES

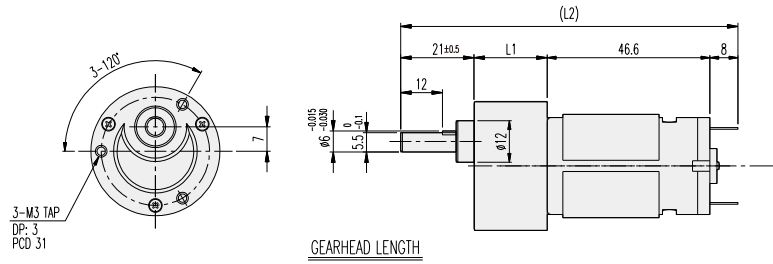

GEARHEAD LENGTH		
RATIO	L1	L2
1/002 ~ 1/030	21	96.6
1/040 ~ 1/180	29	104.6
1/200 ~ 1/2430	33.7	109.3

#### MOTOR PERFORMANCE DATA

MODEL	ITEM	VOLTAGE (DC)	NO LOAD		AT MAX. EFF.			STALL		WEIGHT (g)
			mA	rpm	gf-cm	A	rpm	A	gf-cm	
KD2847T1		12V	170	7300	90	0.65	6300	5	830	110
KD2847T2		24V	90	7300	110	0.4	6300	2.8	870	

#### AT MAXIMUM EFFICIENCY

GEAR	MODEL	KD2847T1		KD2847T2	
		DC 12V		DC 24V	
		rpm	kgf-cm	rpm	kgf-cm
1/0002		3150	0.12	3150	0.14
1/0003		2100	0.17	2100	0.21
1/0005		1260	0.29	1260	0.36
1/0010		630	0.58	630	0.71
1/0015		420	0.79	420	0.96
1/0020		315	1.05	315	1.28
1/0025		252	1.31	252	2
1/0030		210	1.57	210	1.92
1/0040		157.5	1.89	157.5	2.31
1/0050		126	2.36	126	2.89
1/0060		105	2.83	105	3.46
1/0070		90	3.31	90	4.04
1/0080		78.8	3.4	78.8	4.2
1/0083		75.9	3.53	75.9	4.31
1/0090		70	4.25	70	5
1/0100		63	4.25	63	5
1/0120		52.5	5.1	52.5	6
1/0150		42	6	42	6
1/0180		35	6	35	6
1/0200		31.5	6	31.5	6
1/0210		30	6	30	6
1/0240		26.3	6	26.3	6
1/0300		21	6	21	6
1/0360		17.5	6	17.5	6
1/0400		15.8	6	15.8	6
1/0500		12.6	6	12.6	6
1/0600		10.5	6	10.5	6
1/0750		8.4	6	8.4	6
1/0900		7	6	7	6
1/1080		5.8	6	5.8	6
1/1350		4.7	6	4.7	6
1/1620		3.9	6	3.9	6
1/2430		2.6	6	2.6	6

\* 색상의 감속비는 MOTOR와 출력축의 회전방향이 같습니다.